

SPECIFICATIONS

CUSTOMER			
SAMPLE CODE (Rev.)			ZY-FGD1442701V1.(Rev.A)

Customer PRODUCTION CODE _____

Customer Approved

Date:

Approved By	QC Confirmed	Checked By	Designer
			Tony Wang 12/8/2008

Approval For Specifications Only.

* This specification is subject to change without notice.

Approval For Specifications and Sample.

RECORDS OF REVISION

Date	Rev.	Description	Note	Page
2008/10/12	0	Preliminary		

Total :-- Pag

Contents

1.Introduction.....	4
2.General specification.....	5
3..Mechanical drawing.....	6,7
4.Absolute maximum ratings.....	8
5.Electrical characteristions.....	8
6.Touch panel specifications.....	8
7.Optical characteristics.....	9,10,11
8.Pin assignment.....	12
9.Block diagram.....	13
10.LCM quality criteria.....	13
11.Packing method.....	14

1.Introduction

1.1 Scope of application

This specification applies to the Negative type TFT transmissive dot matrix LCD

Module that is supplied by **Wintektion Technology Co., Ltd.**

This LCD module should be designed for mobile phone use. LCD specification: 12:00, Dots 128*RGB*128. As to basic specification of the driver IC, refer to the IC (ST7735) specification and datasheet.

1.2 Structure:

Double display structure:

TFT Module+FPC+BL

Full 65k Color 1.44 inch TFT LCD size for main LCD:

One bare chip with gold bump (COG) Tech:

8-bits interface:

1.3 TFT features:

Structure: TFT PANNEL +IC+FPC

Transmissive Type LCD

128 dot-source and 128 dot-gate outputs:

65K Color.

White LED back light;

1.4 Application;

Mobile phone MP3

1.5 This module uses ROHS material

2. General specification

ITEM	Standard value	Unit
LCD Type	TFT Negative Transmissive	---
Driver element	A-Si TFT Active matrix	---
Number of Dots	128*RGB*128	Dots
Pixel Arrangement	RGB Vertical Stripe	---
Pixel Pitch (W*H)	153(W)*153(H)	um
Display Area	26.496(H)*25.4976(V)	mm
Viewing Direction	12:00	O'clock
Driver IC	ST7735	---
Module Size(W*H*T)	36.50(W)*30.90(H)*2.80(T)	mm
Apptox Weight	TBD	g
Back Light	White LED	
Touch Panel Type	wire Analog Resistive	

3.Mechanical drawing

PIN	SYMB
1	VDD
2	VSS
3	VSS
4	VSS
5	CS0
6	CD
7	RD
8	WR
9	RSTB
10	D0
11	NC
12	D1
13	NC
14	D2
15	NC
16	D3
17	NC
18	D4
19	NC
20	D5
21	NC
22	D6
23	NC
24	D7
25	NC
26	LED-
27	LED+

1. DISPLAY TYPE	TFT NEGATIVE
2. VIEWING DIRECTION	12 O' CLOCK
3. POLARIZER MODE	TRANSMISSIVE
4. OPERATIVE VOLTAGE	3.0V
5. OPERATIVE TEMP.	-20° C TO 70° C
6. STORAGE TEMP.	-30° C TO 80° C
7. CONNECTOR	ST7735
8. LED VOLTAGE	3.0V

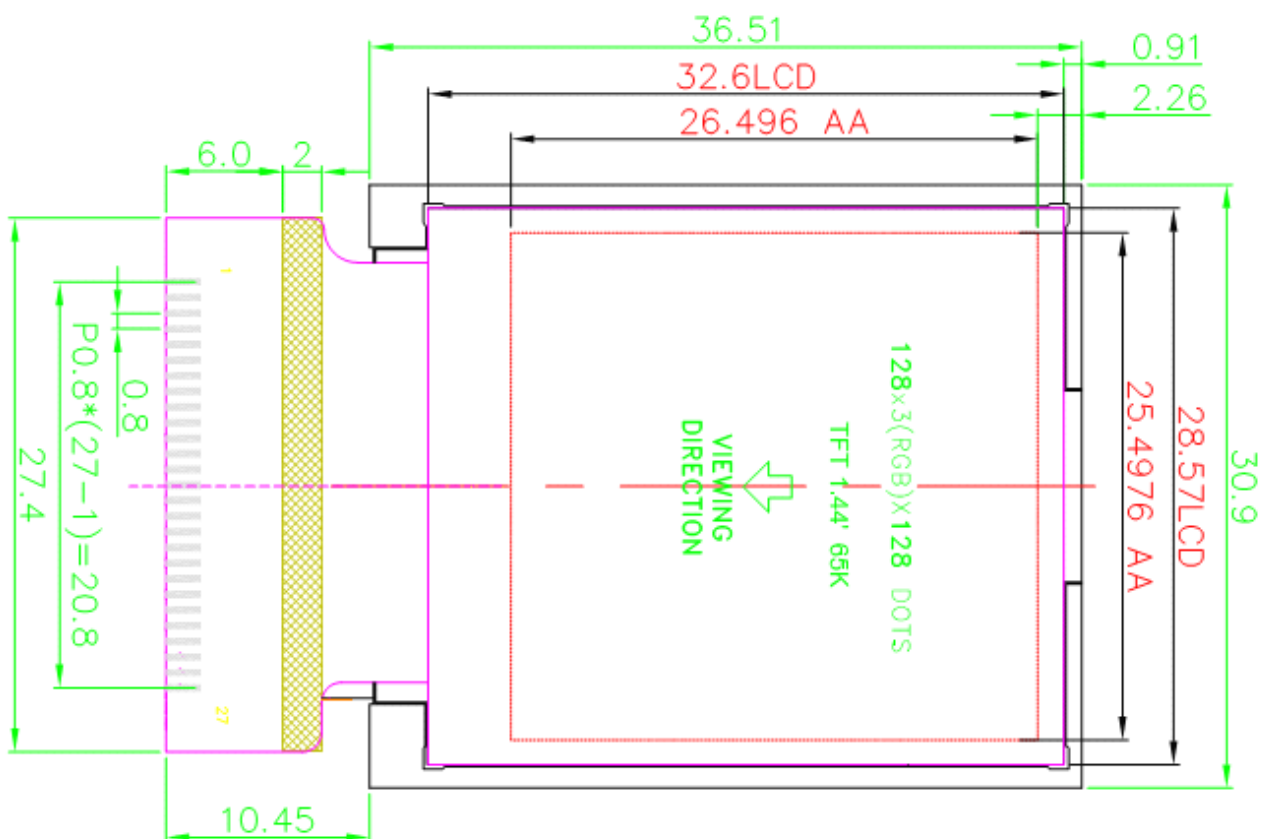

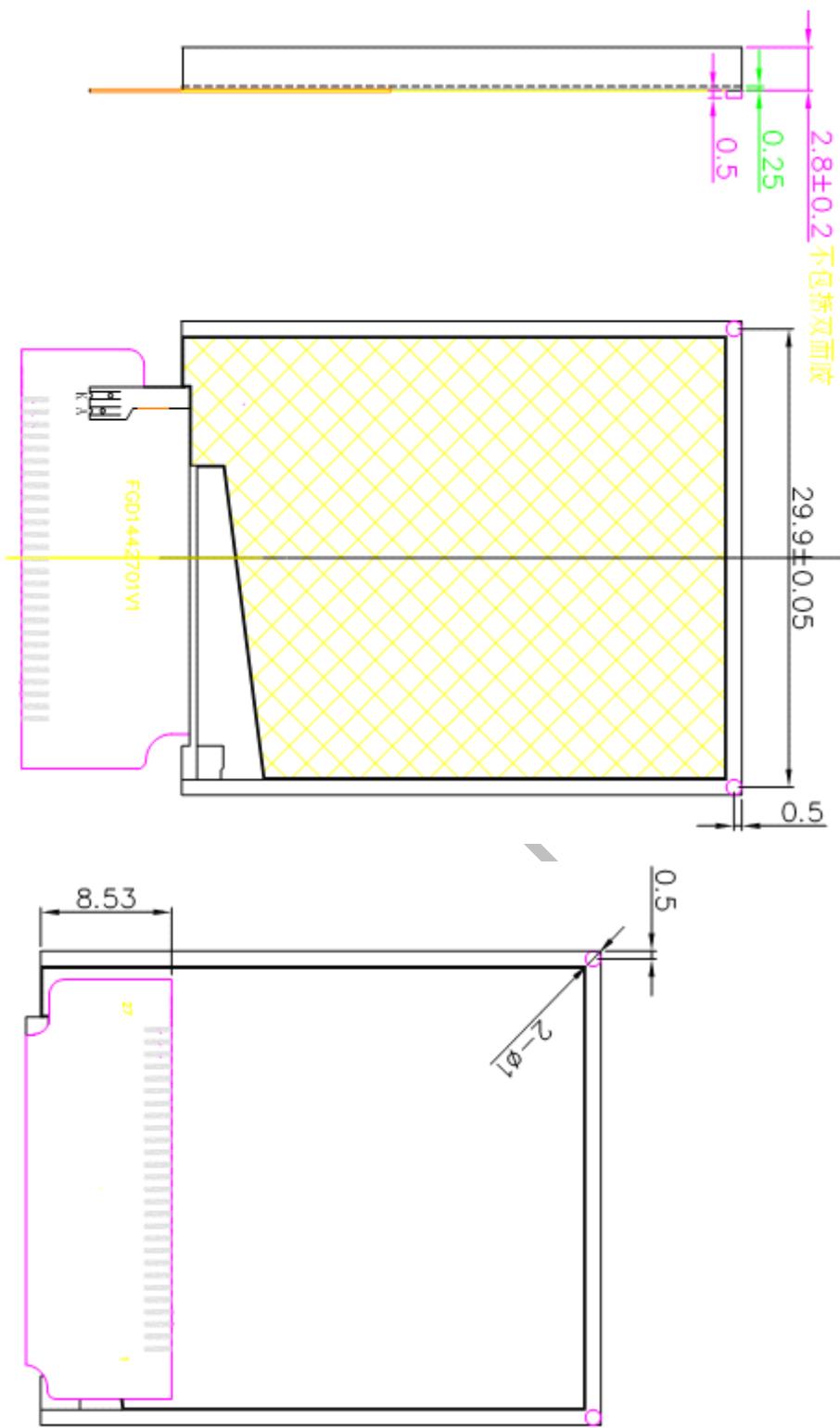

4. Absolute maximum ratings

Parameter	Symbol	Min	Max	Unit
Supply voltage for logic	V_{DD}	-0.3	3.0	V
Input voltage for logic	V_{IN}	-0.5	$V_{DD}+0.3$	V
Supply current(one LED)	I_{LED}		20	mA
Operating temperature	T_{OP}	-20	+70	°C
Storage temperature	T_{ST}	-30	+80	°C

5. Electrical characteristics

Item	Symbol	Min	Typ	Max	Unit	Applicable terminal
Supply voltage for logic	V_{DD}	2.6	2.8	3.0	V	V_{DD}
Input voltage	V_{IL}	-0.3	-	$0.2V_{DD}$	V	
	V_{IH}	$0.8V_{DD}$	-	V_{DD}	V	
Input leakage voltage	I_{LKG}				uA	
LED Forward voltage	V_f	3.0	3.2	3.3	V	
Input backlight current	I_{LED}	-	15	20	mA	With one LED

6. Touch panel specifications

This module has no Touch panel

Central Plains